

Apartment 77, Floor 11

2 Bedroom apartment



Walthamstow Gateway

A new destination by Solum

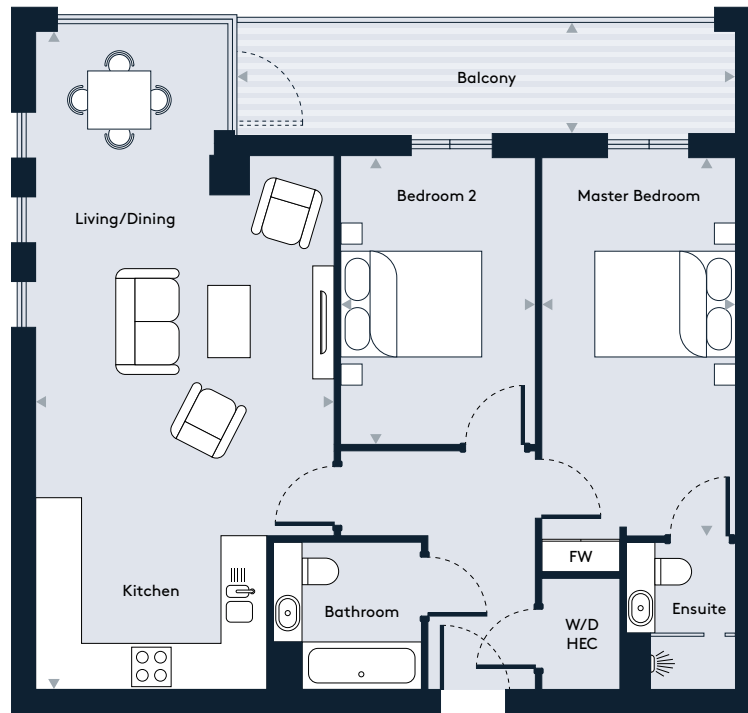

Key

W/D	Washer/Dryer	HEC	Heating/Electrical Components
FW	Fitted Wardrobe		

Dimensions

Room	mm	ft
Living / Dining / Kitchen	4225 x 9208	13'10" x 30'2"
Master Bedroom	2755 x 5332	9'0" x 17'5"
Bedroom 2	2754 x 4035	9'0" x 13'2"
Balcony	7090 x 1396	23'3" x 4'6"
Total Internal Area	78.3 m²	843 sq ft

Floor Plate

