

# Apartment 31, Floor 5

## 2 Bedroom apartment

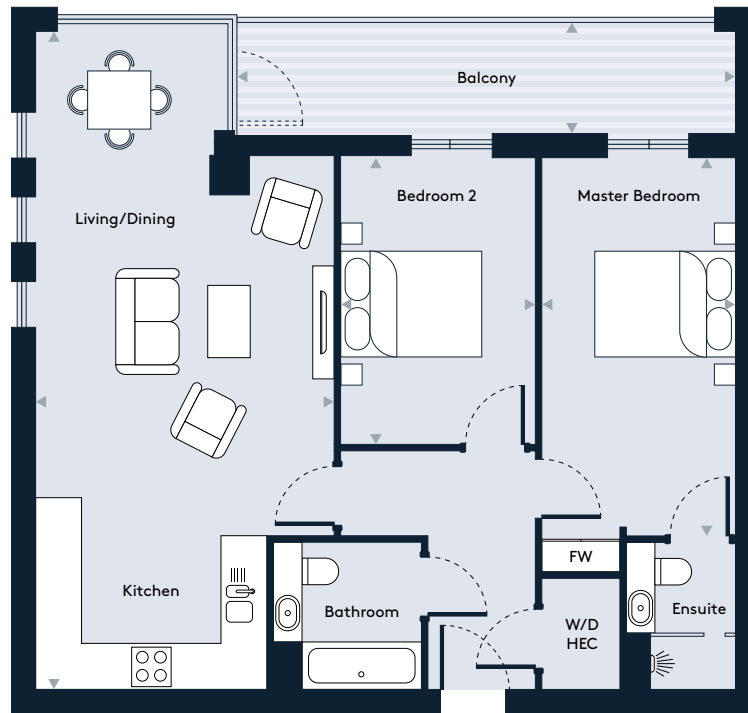

**Walthamstow Gateway**  
A new destination by Solum



### Key

W/D	Washer/Dryer	HEC	Heating/Electrical Components
FW	Fitted Wardrobe		

### Dimensions

Room	mm	ft
Living / Dining / Kitchen	4225 x 9208	13'10" x 30'2"
Master Bedroom	2755 x 5332	9'0" x 17'5"
Bedroom 2	2754 x 4035	9'0" x 13'2"
Balcony	7090 x 1396	23'3" x 4'6"
<b>Total Internal Area</b>	<b>78.3 m<sup>2</sup></b>	<b>843 sq ft</b>

### Floor Plate

