

# Apartment 30, Floor 5

## 2 Bedroom apartment

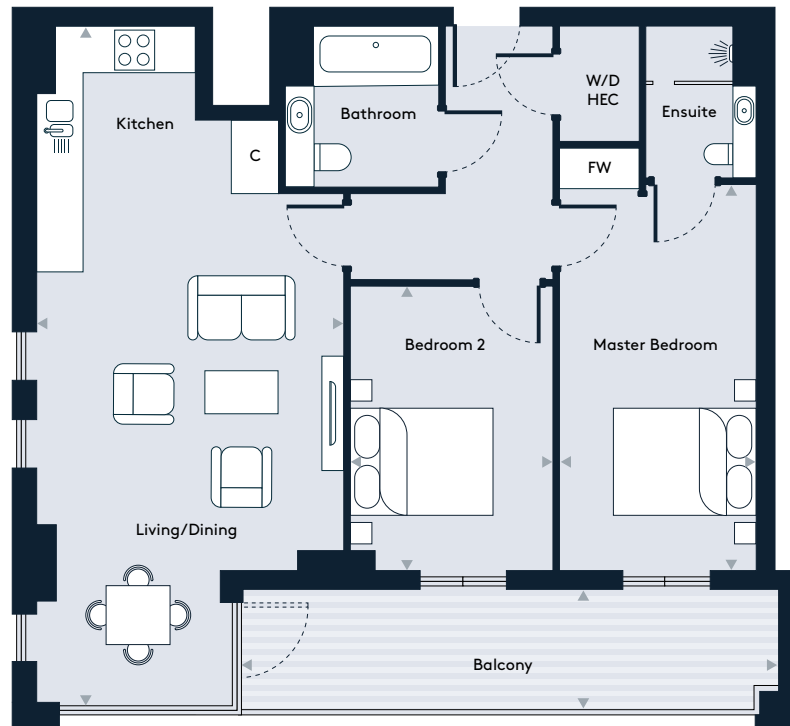

**Walthamstow Gateway**  
A new destination by Solum



### Key

W/D	Washer/Dryer	HEC	Heating/Electrical Components
FW	Fitted Wardrobe	C	Cupboard

### Dimensions

Room	mm	ft
Living / Dining / Kitchen	3840 x 7547	12'7" x 24'9"
Master Bedroom	2967 x 4544	9'8" x 14'10"
Bedroom 2	2850 x 3245	9'4" x 10'7"
Balcony	1431 x 7445	4'8" x 24'5"
<b>Total Internal Area</b>	<b>74.7 m<sup>2</sup></b>	<b>804 sq ft</b>

### Floor Plate

